

notes
 this drawing and design is the copyright of aja architects llp and must not be reproduced in part or in whole without prior written consent. contractors must verify all dimensions on site before commencing work or preparing shop drawings if in doubt ASK.

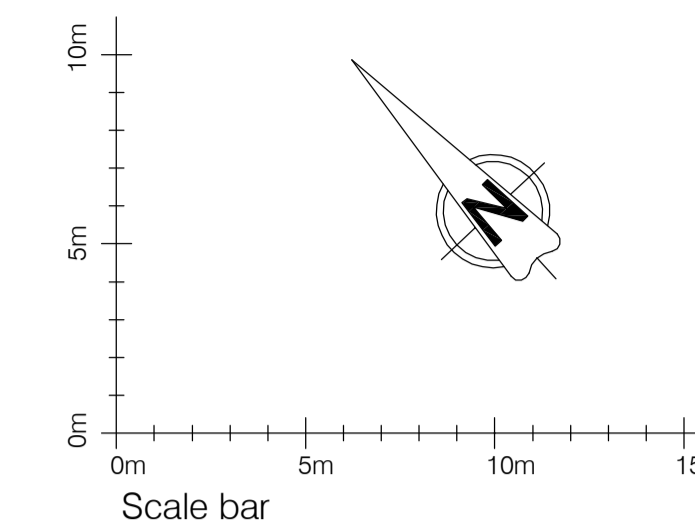

Proposals and layout are subject to survey, site investigation and statutory approvals.
 Site boundaries interpolated from HM Land Registry plan HD243902 (1988).

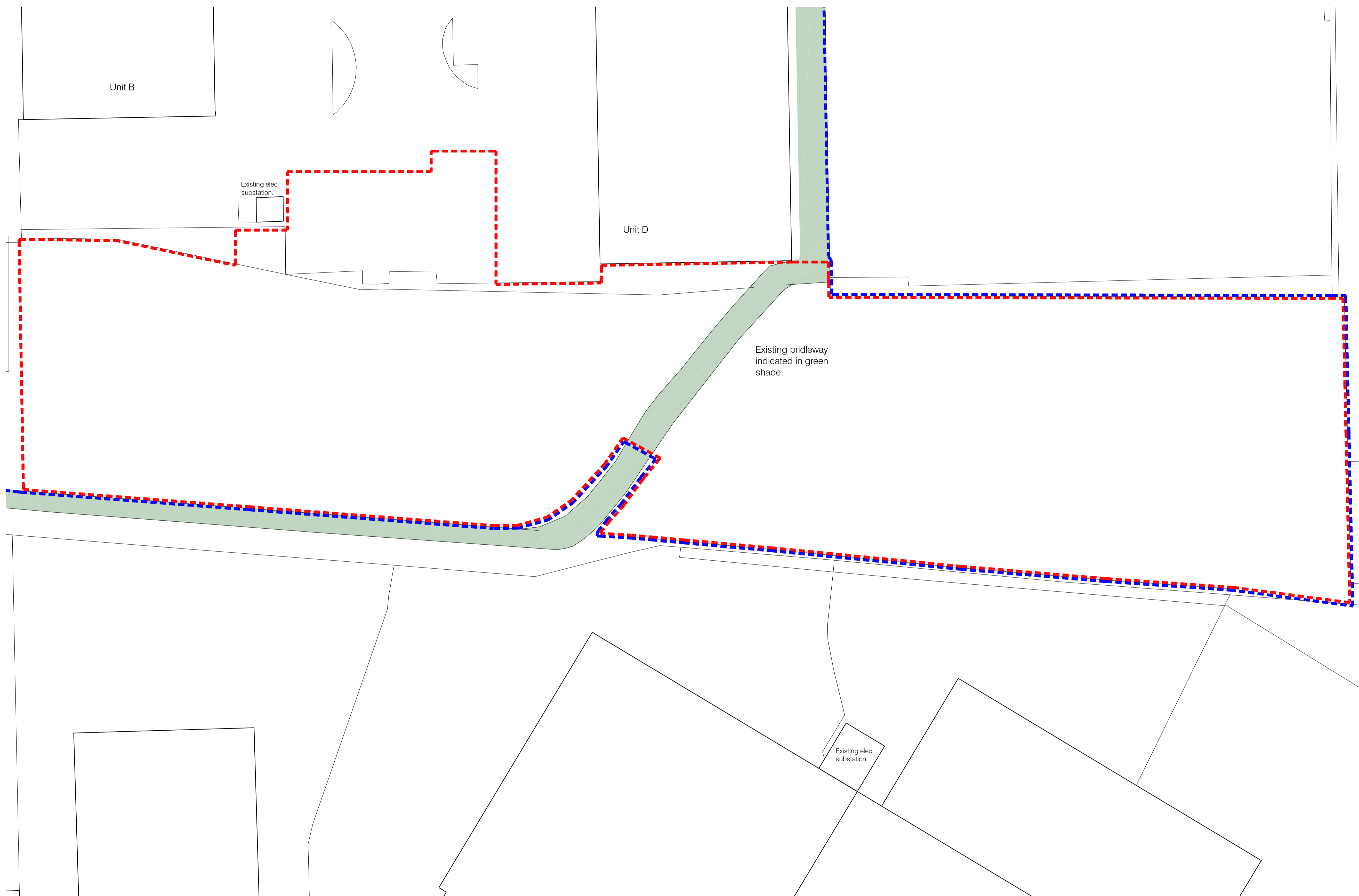

no.	date	revision	by
+	+	+	+



aja architects llp
 1170 Elliott Court
 Herald Avenue
 Coventry Business Park
 COVENTRY CV5 6UB
 T: 024 7625 3200
 F: 024 7625 3210
 E: aja@aja-architects.com
 W: www.aja-architects.com

aja architects llp is a limited liability partnership registered in England No. OC324721
 client

Aviva

project

Proposed B2/ B8
 Development
 Watchmead
 Welwyn Garden City

drawing

Site Plan as Existing

scale 1:200 @ A1 drawn ARO

checked SP date 27/07/2012

no

5311 - 026