



**WELWYN
HATFIELD**

Working better, together

Ka Ng
Corporate Director
Resources, Environment and Cultural Services

Reply To: Parking Services

Our Ref: MD/12099

Date: 13th May 2019

Tel: 01707 357000

Email: parking@welhat.gov.uk

The Occupier
«SAOName» «SAONumber» «PAOName»
«StreetName»
Hatfield
«Postcode»

Dear Resident /Occupier

French Horn Lane Area Parking Consultation – Modification no.2

Further to our letter sent 4th March and the public Notice 20th March regarding the proposal for new parking restrictions in various roads Hatfield. As a consequence of responses received from Glebe Court sheltered housing to the Notice of Intention published on 20th March 2019, the Council is proposing to modify the order The Borough of Welwyn Hatfield (Various Roads, French Horn Lane Area, Hatfield) (Restriction of Waiting, Parking Places and Permit Parking Zones) Order 2019. The effect of the modification shown in the attached plan will be as follows:

- To change the proposed restriction outside Glebe Court from “permit parking only” to parking bays restricted to “2 hours no return within 2 hours or permit parking zone B02”

Should you wish to make any representations regarding the proposed modification please write to: Martin Donohoe, Parking Services, Council Offices, Welwyn Garden City, AL8 6AE, or email: parking@welhat.gov.uk, representations concerning the proposed modifications should be submitted, so as to be received by the Council no later than 28th May.

Consulting on this scheme is a statutory duty of Welwyn Hatfield Borough Council. Any personal data you provide in responding to this Notice will be treated as confidential but will be shared with Borough Officers, Borough Councillors and contracted third parties who are involved in the statutory process. We will not share identifiable data with third parties outside of the statutory process. Guidance on your rights in respect of personal data are published in the Privacy Policy on our website at www.welhat.gov.uk/privacy-notice.

All documents relating to the proposal may be viewed on the webpage below www.welhat.gov.uk/frenchhornlanearea

Copies of the modification notice will also be erected near the sites affected. If you have any questions about the consultation process please do not hesitate to contact us.

Sent on behalf of

Parking Services

Welwyn Hatfield Borough Council, The Campus, Welwyn Garden City, Herts AL8 6AE
DX 30075, Welwyn Garden City 1

Tel: 01707 357000

www.welhat.gov.uk



100metres
This line measures 100mm on original A3 paper

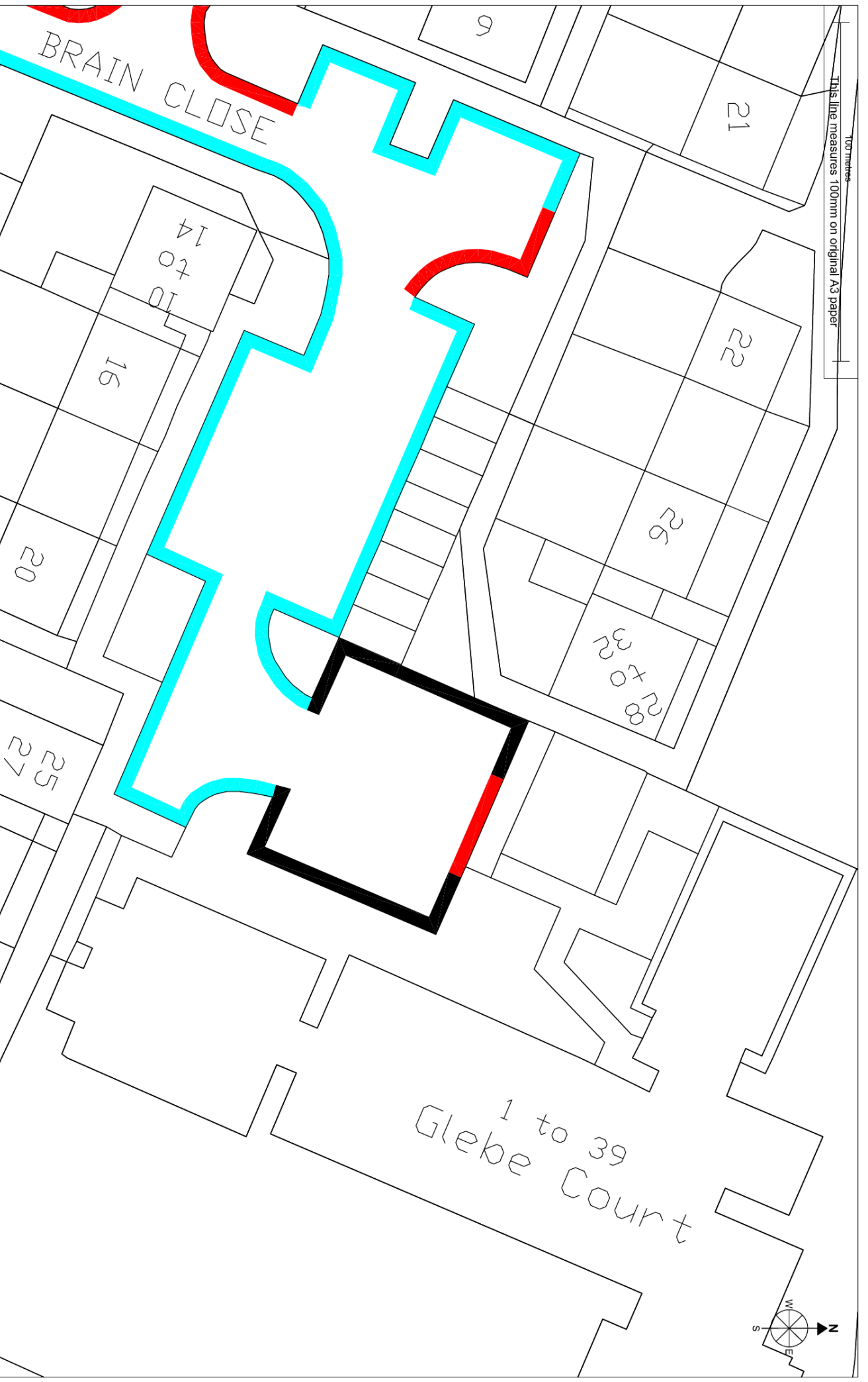

- Key
- Proposed double yellow lines
 - Proposed permit parking only for zone B02
 - Proposed parking bays Monday to Friday 8am to 6pm, 2 hours no return within 2 hours or permit holders for zone B02

Title
- French Horn Lane Area Modification letter no.2
Area 1 Glebe Court in Brain Close

Scale - 1:250 on A3
Drawn - 13/05/2019
By - MD Parking Services
Drawing - 1



© Crown Copyright All rights reserved Welwyn Hatfield
Borough Council License No. LA 100019547 2019